

宗 地 图

XDG-2020-39号

单位: m · m²

3490.00-40532.00,
3490.00-40532.25,
3490.25-40532.00

320292013084GB00112

北

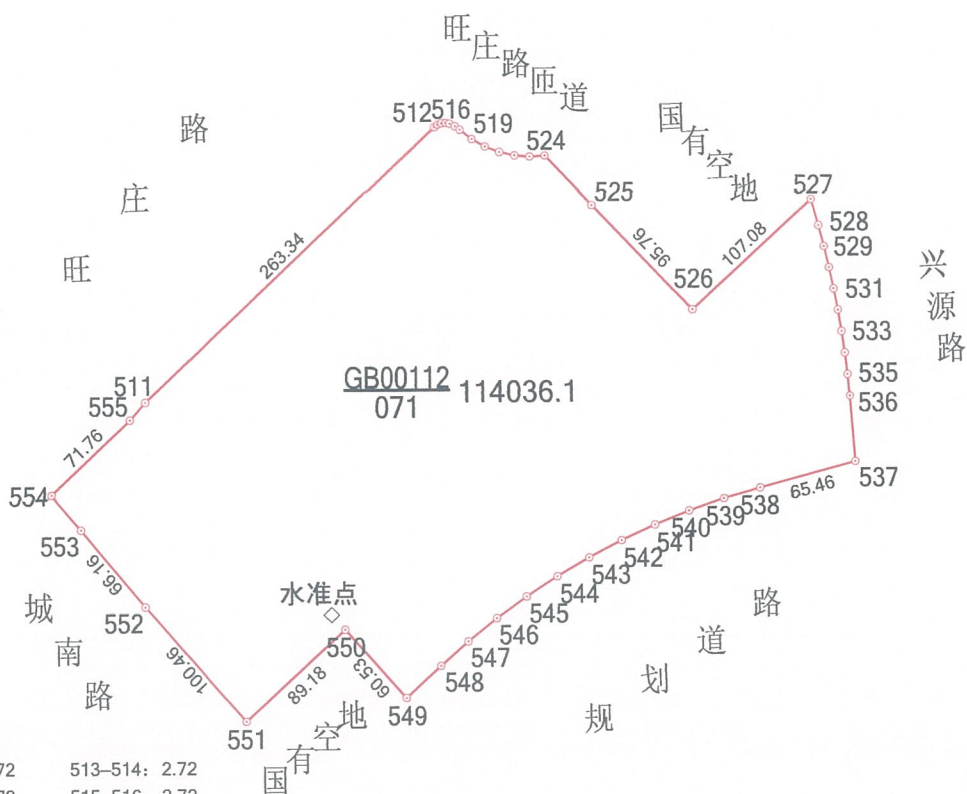

512-513: 2.72	513-514: 2.72
514-515: 2.72	515-516: 2.72
516-517: 3.95	517-518: 3.95
518-519: 10.11	519-520: 10.11
520-521: 10.11	521-522: 10.11
522-523: 10.11	523-524: 10.11
524-525: 45.53	527-528: 17.92
528-529: 14.31	529-530: 14.31
530-531: 14.31	531-532: 14.31
532-533: 14.31	533-534: 14.31
534-535: 14.31	535-536: 14.31
536-537: 43.35	538-539: 24.41
539-540: 24.41	540-541: 24.41
541-542: 24.41	542-543: 24.41
543-544: 24.41	544-545: 24.41
545-546: 24.41	546-547: 24.41
547-548: 24.41	548-549: 31.07
553-554: 30.54	555-511: 15.51



注: 该地块内有省级水准点。

1:5000

绘图员: 吴景宇

审核员: 吴景宇

2020年5月19日

界址点成果表

宗地号 320292013084GB00112

权利人 XDG-2020-39号

宗地面积 (平方米) 114036.1

界址点坐标

顺序号	点号	坐标		边长 (m)	备注
		X (m)	Y (m)		
1	511	3490383.296	40532233.516	263.34	
2	512	3490564.018	40532425.054	2.72	
3	513	3490565.600	40532427.272	2.72	
4	514	3490566.525	40532429.834	2.72	
5	515	3490566.724	40532432.552	2.72	
6	516	3490566.183	40532435.222	3.95	
7	517	3490564.517	40532438.801	3.95	
8	518	3490562.180	40532441.983	10.11	
9	519	3490555.980	40532449.973	10.11	
10	520	3490550.996	40532458.773	10.11	
11	521	3490547.332	40532468.199	10.11	
12	522	3490545.065	40532478.055	10.11	
13	523	3490544.242	40532488.135	10.11	
14	524	3490544.879	40532498.228	45.53	
15	525	3490511.892	40532529.610	95.76	
16	526	3490442.811	40532595.925	107.08	
17	527	3490515.004	40532675.015	17.92	
18	528	3490497.763	40532679.896	14.31	
19	529	3490483.894	40532683.435	14.31	
20	530	3490469.951	40532686.672	14.31	
21	531	3490455.941	40532689.607	14.31	

界址点成果表

宗地号 320292013084GB00112

权利人 XDG-2020-39号

宗地面积 (平方米) 114036.1

界址点坐标

顺序号	点号	坐标		边长 (m)	备注
		X (m)	Y (m)		
21	531	3490455.941	40532689.607	14.31	
22	532	3490441.871	40532692.236	14.31	
23	533	3490427.748	40532694.560	14.31	
24	534	3490413.577	40532696.577	14.31	
25	535	3490399.366	40532698.287	14.31	
26	536	3490385.121	40532699.687	43.35	
27	537	3490341.893	40532702.993	65.46	
28	538	3490324.903	40532639.778	24.41	
29	539	3490318.005	40532616.367	24.41	
30	540	3490309.993	40532593.315	24.41	
31	541	3490300.885	40532570.673	24.41	
32	542	3490290.703	40532548.493	24.41	
33	543	3490279.469	40532526.827	24.41	
34	544	3490267.209	40532505.724	24.41	
35	545	3490253.952	40532485.234	24.41	
36	546	3490239.728	40532465.402	24.41	
37	547	3490224.570	40532446.275	24.41	
38	548	3490208.512	40532427.897	31.07	
39	549	3490187.513	40532404.994	60.53	
40	550	3490232.825	40532364.864	89.18	
41	551	3490172.553	40532299.130	100.46	

